



## NUC **Fanless** Embedded System



### Hawk Series



HBJC310U91-2930-B  
HBJC310U91W-2930-B



HBJC310U91-2930-S  
HBJC310U91W-2930-S

### Specification:

■ Dimension (W*D*H)	■ 116 * 110 * 49 mm
■ Construction	■ Top cover & I/O plate –aluminum; Base- metal
■ Colors	■ Black / HBJC310U91-2930-B, HBJC310U91W-2930-B ■ Sliver / HBJC310U91-2930-S, HBJC310U91W-2930-S
■ MB model	■ JNU91-2930
■ CPU	■ INTEL® Bay Trail-M N2930 SoC Processor (1.83GHz, 7.5W TDP)
■ BIOS	■ AMI UEFI
■ Memory	■ 1 * SO-DIMM slot (Max to 8GB)
■ Storage Space	■ 1 * full size Mini PCI-E slot for m-SATA Device
■ Display Interface	■ 2 * HDMI
■ Network	■ 1 * RJ45 (Giga LAN) ■ WiFi (HBJC310U91W-2930-B & HBJC310U91W-2930-S only)
■ Audio	■ 1 * Line out
■ Front I/O Port	■ 1 * USB 3.0 ■ 1 * COM
■ Rear I/O Port	■ 2 * USB 2.0, 2 * HDMI, 1 * GigaLAN, 1 * Line out, 1 * 12V DC-in
■ Expansion Slot	■ 1 * half size Mini PCI-E slot
■ Power Source	■ DC-12V Jack input ■ Adapter : AC_90~240V / DC_12V_3A/36W
■ Certification	■ EMC : CE , FCC ■ Safety : RoHS , ErP

<ul style="list-style-type: none"> <li>Environment</li> </ul>	<ul style="list-style-type: none"> <li>Operating Temperature : -10°C~60°C with air flow (mSATA)</li> <li>Storage Temperature : -20°C~80°C</li> <li>Vibration During Operation : N/A</li> <li>Shock During Operation : N/A</li> </ul>
<ul style="list-style-type: none"> <li>Mounting Bracket</li> </ul>	<ul style="list-style-type: none"> <li>Wall/VESA/DIN Rail combo mounting Kit</li> </ul>
<ul style="list-style-type: none"> <li>Packing</li> </ul>	<ul style="list-style-type: none"> <li>Net Weight : 0.9KG</li> <li>Gross Weight : 1.6KG</li> <li>Color Box Dimension : 180(W) x 190(D) x 92(H) mm</li> </ul>

## External I/O :

No	Specification
1	Power Switch
2	Power LED (blue Light)
3	COM Port
4	USB 3.0 Port (A Type)
5	Gigabit LAN Port
6	WiFi Port (option)
7	DC-in 12V input Port
8	Anti-theft fixing holes
9	HDMI Port
10	Audio Port
11	USB 2.0 Port

Front

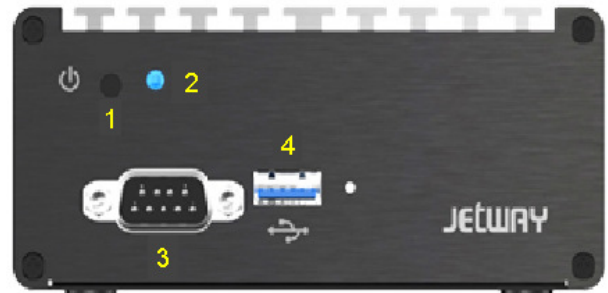

Front I/O Port

Rear

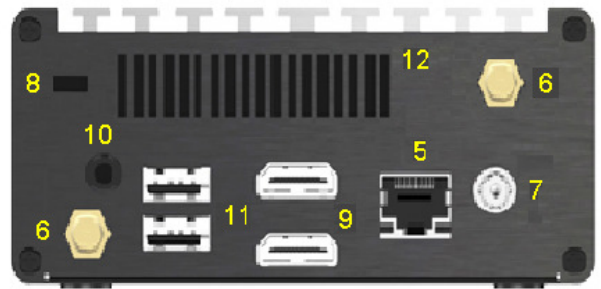

Rear I/O Port

## Packing List :

Parts Number	Description	Set
-----	JBC310U91-2930-B	1
G03-JC310QIG01-F	310 Series Quick Installation Guide	1
G02-DVD20-A1-WF	Mini-ITX INTEL Bay Trail DVD Driver	1
HLMAP-FSP036-F	Adapter 12V_3A_36W	1
-----	Power cord	1
-----	JC310 WALL + VESA + DIN rail mount (Black)	1
LCSCBJC3XX-F	Screw Pack	1
HCS3XXDINRAILPS-F	Din Rail Clip	1

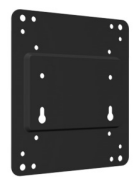

WALL Mount + VESA

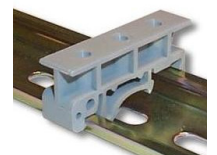

Din Rail Clip



QIG



Adapter



DVD Driver