



NUC Fanless Embedded System



Specification:

■ Dimension (W*D*H)	■ 116 * 110 * 65 mm
■ Construction	■ Top cover & I/O plate –aluminum; Base- metal
■ Colors	<ul style="list-style-type: none"> ■ Black / JBC320U93(W)-2807-B ■ Black / JBC320U93(W)-2930-B ■ Sliver / JBC320U93(W)-2807-S ■ Sliver /JBC320U93(W)-2930-S <div style="text-align: right; border: 1px solid black; padding: 2px; display: inline-block;">Hawk Series</div>
■ MB model	■ JNU93-2807 (2930)
■ CPU	<ul style="list-style-type: none"> ■ INTEL® Bay Trail-M N2807 SoC Processor ■ INTEL® Bay Trail-M N2930 SoC Processor
■ BIOS	■ AMI UEFI
■ Memory	■ 1 * SO-DIMM slot (Max to 8GB)
■ Storage Space	<ul style="list-style-type: none"> ■ 1 * full size Mini PCI-E slot for m-SATA Device ■ 1 * 2.5" SATA HDD
■ Display Interface	■ 2 * HDMI
■ Network	<ul style="list-style-type: none"> ■ 2 * RJ45 (Giga LAN) ■ WiFi (HBJC320U93W-2930-B & HBJC320U93W-2930-S only)
■ Audio	■ 1 * Line out support SPDIF
■ Front I/O Port	<ul style="list-style-type: none"> ■ 1 * USB 2.0 ■ 1 * USB 3.0 ■ 1 * COM (Support RS232/422/485 & 5V/12V Selectable)
■ Rear I/O Port	<ul style="list-style-type: none"> ■ 2 * USB 2.0 ■ 2 * RJ-45 GigaLAN ■ 1 * Line-out (Support SPDIF) ■ 1 * DC-in jack
■ Expansion Slot	■ 1 * half size Mini PCI-E slot
■ Power Source	<ul style="list-style-type: none"> ■ 9~24V Wide range DC input ■ Adapter : AC_90~240V / DC_12V_3A/ 36W
■ Certification	■ EMC : CE , FCC

	<ul style="list-style-type: none"> ■ Safety : RoHS , ErP
<ul style="list-style-type: none"> ■ Environment 	<ul style="list-style-type: none"> ■ Operating Temperature : -10°C~60°C with air flow (mSATA) ■ Storage Temperature : -20°C~80°C ■ Vibration During Operation : N/A ■ Shock During Operation : N/A
<ul style="list-style-type: none"> ■ Mounting Bracket 	<ul style="list-style-type: none"> ■ Wall/VESA/DIN Rail combo mounting Kit
<ul style="list-style-type: none"> ■ Packing 	<ul style="list-style-type: none"> ■ Net Weight : 1.2KG ■ Gross Weight : 1.6KG ■ Color Box Dimension : 158(W) x 167(D) x 123.6(H) mm

External I/O :

No	Specification
1	Power Switch
2	Power LED (blue Light)
3	COM Port
4	1 * USB 3.0 + 1 * USB 2.0 Port (A Type)
5	Gigabit LAN Ports
6	WiFi Port (option)
7	9~24V Wide range DC input Port
8	Anti-theft fixing holes
9	HDMI Ports
10	Audio Port (Line-out support SPDIF)
11	USB 2.0 Ports

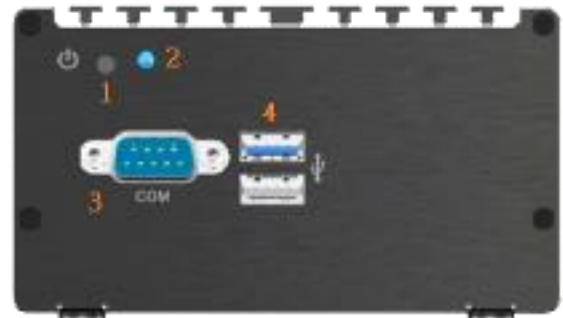

Front

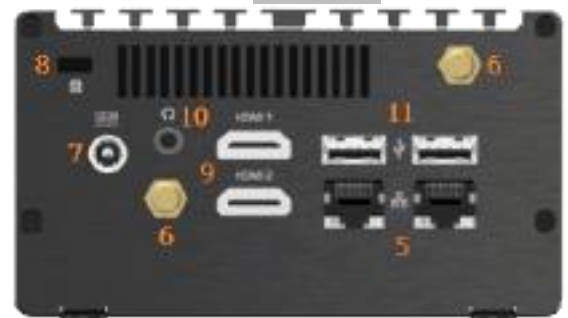

Rear



Packing List :

Parts Number	Description	Set
-----	JBC320U93(W)-2807(2930)-B(S)	1
G03-JC310QIG01-F	310 Series Quick Installation Guide	1
G02-DVD20-A1-WF	Mini-ITX INTEL Bay Trail DVD Driver	1
HLMAP-FSP036-F	Adapter 12V_3A_36W	1
-----	Power cord	1
-----	JC310 WALL + VESA + DIN rail mount (Black)	1
LCSCHBJC3XX-F	Screw Pack	1
-----	SATA + POWER CABLE	1
HCS3XXDINRAILPS-F	Din Rail Clip	1



QIG



Adapter

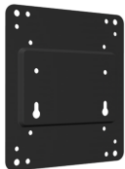

WALL Mount + VESA

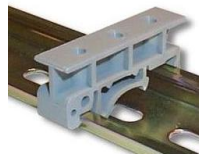

Din Rail Clip



DVD Driver



SATA + POWER CABLE